

Drawing Schedule

M222D	EL-01	LIGHTING PLAN
M222D	EL-02	SINGLE LINE DIAGRAM AND DETAILS
M222D	LC-01	ILLUMINANCE CALCULATIONS

Legend of Symbols

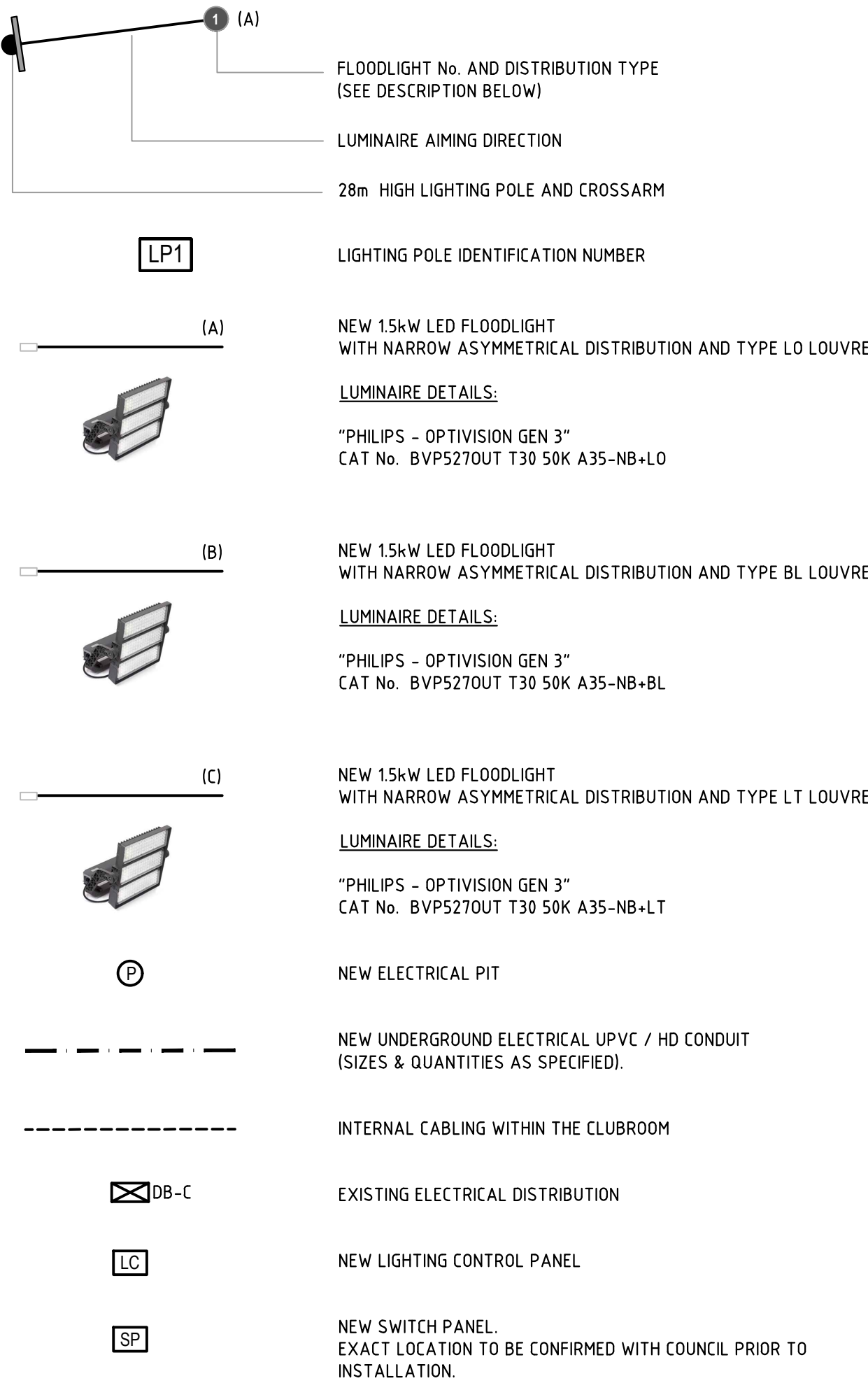

Scope of Works :

- REMOVAL AND DISPOSAL OF EXISTING LIGHT POLES AND ASSOCIATED ITEMS. ALLOW TO RETURN EXISTING EQUIPMENT TO THE COUNCIL, IF RETURNED.
- NEW LIGHT POLES & CROSS-ARMS, POLE FOOTINGS, LUMINAIRES AND ASSOCIATED ITEMS
- NEW CONDUIT AND CABLING
- NEW LIGHTING CONTROL AND SWITCH PANEL(TO BE LOCATED ON EXTERNAL WALL OF BUILDING - OR ALTERNATIVE LOCATION AS NOMINATED BY CLUB)
- CONTROL SYSTEM TO BE EQUIPPED WITH DIMMING CAPABILITY, COMPLETE WITH PUSH BUTTON SWITCH PANEL TO ALLOW USERS TO SELECT PRE-SET LIGHTING LEVELS (REFER DWG. EL-02 FOR DETAILS).
- AIMING OF NEW LUMINAIRES, INCLUDING INITIAL AIMING TO BE CARRIED OUT DURING DAY LIGHT HOURS AND FINAL AIMING TO BE CARRIED OUT AT NIGHT.
- TESTING AND COMMISSIONING OF LIGHTING SYSTEM UPON COMPLETION OF WORKS, INCLUDING FINAL AIMING TO ACHIEVE REQUIRED ILLUMINANCE LEVELS AND UNIFORMITY.
- AS-BUILT DRAWINGS, OPERATION AND MAINTENANCE MANUALS.
- OTHER WORKS AS REQUIRED.

Notes :

- DO NOT SCALE OFF DRAWING.
- TENDERERS SHALL VISIT SITE TO DETERMINE EXISTING CONDITIONS.
- TENDERERS TO DETERMINE EXACT LOCATION OF EXISTING EQUIPMENT.
- PROVIDE SURGE PROTECTION WITHIN EACH POLE BASE (EQUAL TO OAK ELECTRONICS DS254-VG-400)
- REFER STRUCTURAL DRAWINGS IN ELECTRICAL SPECIFICATION FOR POLE FOUNDATION DETAILS.
- PROVIDE 'SEALED' CONDUIT ENTRY TO BUILDING (PROVIDE STEEL CABLE GUARD FOR MECHANICAL PROTECTION OF ENTRY CONDUIT).
- INTERNAL CABLING WITHIN BUILDING TO BE CONCEALED, OR ALTERNATIVELY, TO BE ENCLOSED IN SURFACE MOUNTED DUCT AT HIGH LEVEL.
- CONDUIT ROUTES SHOWN ARE INDICATIVE ONLY. EXACT CONDUIT ROUTES TO BE DETERMINED DURING CONSTRUCTION TO SUIT SITE CONDITIONS AND TO PREVENT DAMAGE TO EXISTING PARK INFRASTRUCTURE, EQUIPMENT AND FURNITURE. OBTAIN APPROVAL FOR CONDUIT ROUTES FROM COUNCIL PRIOR TO INSTALLATION.
- ALL LUMINAIRES TO BE DALI DIMMABLE
- STRUCTURAL CERTIFICATION OF POLES AND FOOTINGS MUST BE SUPPLIED, TO OBTAIN BUILDING PERMIT, BEFORE BEGINNING WORKS.
- PROVIDE AS BUILT DRAWINGS AND OPERATING MANUALS FOR THE NEW INSTALLATION.
- PROVIDE 12 MONTH DEFECTS LIABILITY/WARRANTY PERIOD FOR THE NEW INSTALLATION.
- UPON COMPLETION OF WORKS, PROVIDE A CERTIFICATE OF ELECTRICAL SAFETY, TO BE INCLUDED IN THE O & M MANUALS.
- THE WORK SHALL COMPLY WITH THE REQUIREMENTS OF AS/NZS 3000, THE VICTORIAN SERVICE AND INSTALLATION RULES (VSIIR) AND ANY OTHER RELEVANT STANDARDS OR AUTHORITY REQUIREMENTS.
- INCIDENTAL WORK : THE WORK SHALL INCLUDE ALL NECESSARY MINOR AND INCIDENTAL WORK REQUIRED TO PROVIDE A COMPLETE AND FULLY FUNCTIONING ELECTRICAL SERVICES INSTALLATION WHICH IMPLEMENTS THE INTENT AND REQUIREMENTS OF THE DESIGN DRAWINGS.
- SUPPLY ALL LABOUR, MATERIAL AND EQUIPMENT, WHETHER MENTIONED IN DETAIL OR NOT, REQUIRED TO LEAVE THE INSTALLATION IN FULL WORKING ORDER.

Existing Underground Services

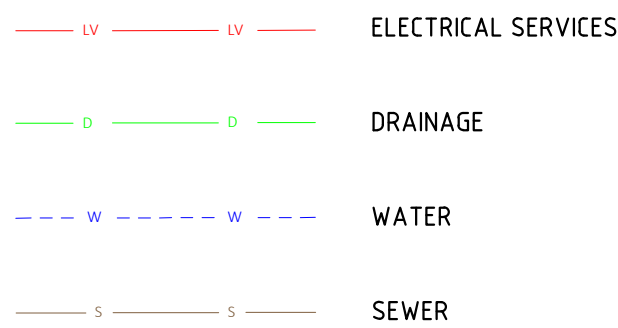

EXISTING UNDERGROUND SERVICES:

THE CONTRACTOR SHALL IDENTIFY EXISTING UNDERGROUND SERVICES BEFORE THE COMMENCEMENT OF WORKS, TO ENSURE THAT THE SERVICES ARE NOT DAMAGED DURING CONSTRUCTION. THIS SHALL INCLUDE (BUT NOT BE LIMITED TO):

- SERVICES LOCATOR TO IDENTIFY AND MARK OUT SERVICES ROUTES
- DIAL-BEFORE-YOU-DIG SEARCH
- LIAISON WITH THE COUNCIL TO OBTAIN ALL RELEVANT RECORDS

THE COSTS FOR THE REPAIR OF ANY SERVICES DAMAGED DUE TO THE CONSTRUCTION WORKS SHALL BE PAID BY THE CONTRACTOR.

KEELEY PARK, CLAYTON SOUTH: EAST OVAL SPORTS LIGHTING UPGRADE

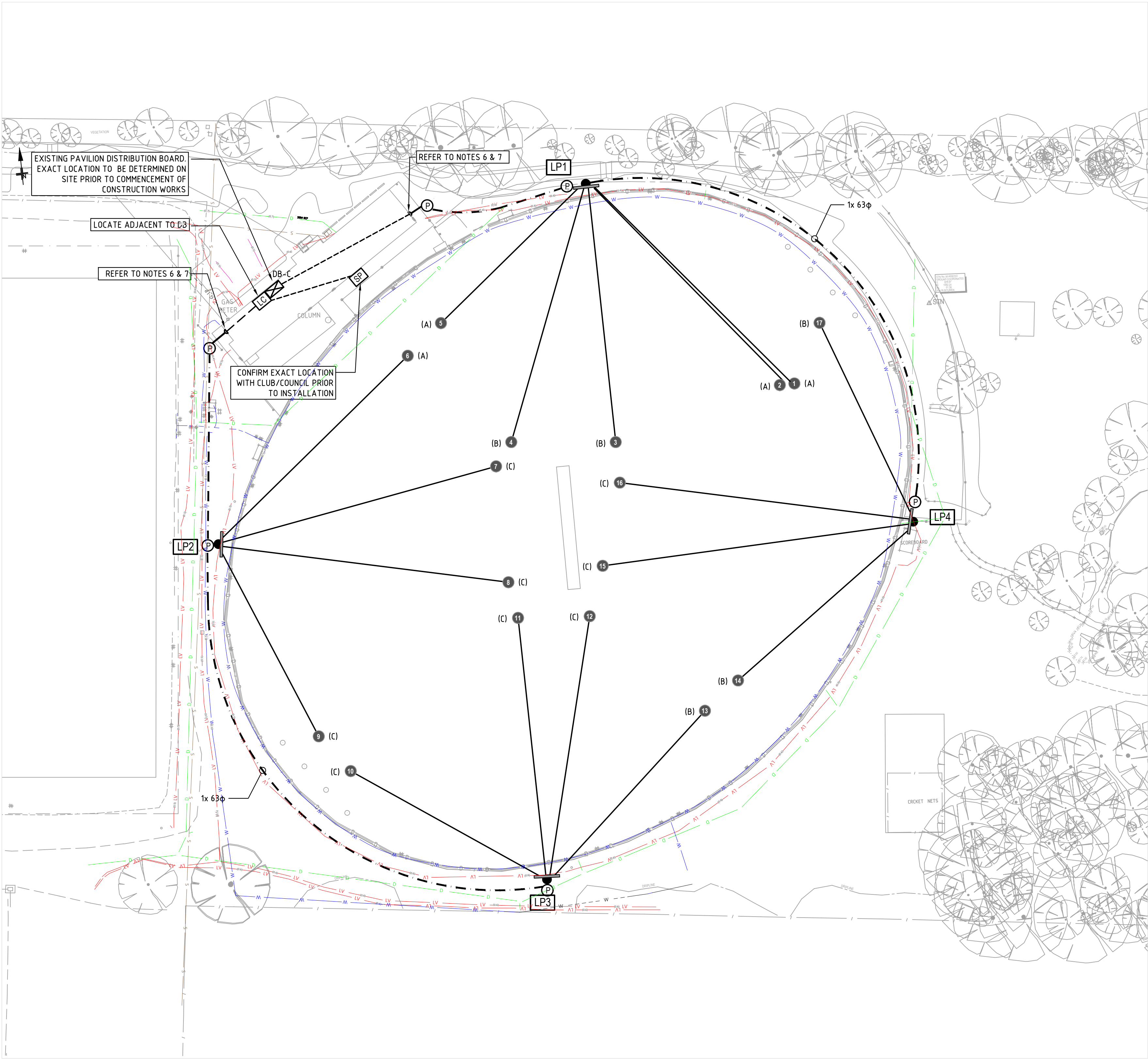

Luminaire Schedule

FLOODLIGHT No.	LIGHT POLE No.	LUMINAIRE TYPE	LUMINAIRE TILT ANGLE
1	LP1	(A)	28°
2	LP1	(A)	28°
3	LP1	(B)	31°
4	LP1	(B)	31°
5	LP1	(A)	27°
6	LP2	(A)	27°
7	LP2	(C)	31°
8	LP2	(C)	31°
9	LP2	(C)	25°
10	LP3	(C)	25°
11	LP3	(C)	31°
12	LP3	(C)	31°
13	LP3	(B)	26°
14	LP4	(B)	26°
15	LP4	(C)	31°
16	LP4	(C)	31°
17	LP4	(B)	22°

Luminaire Aiming Coordinates

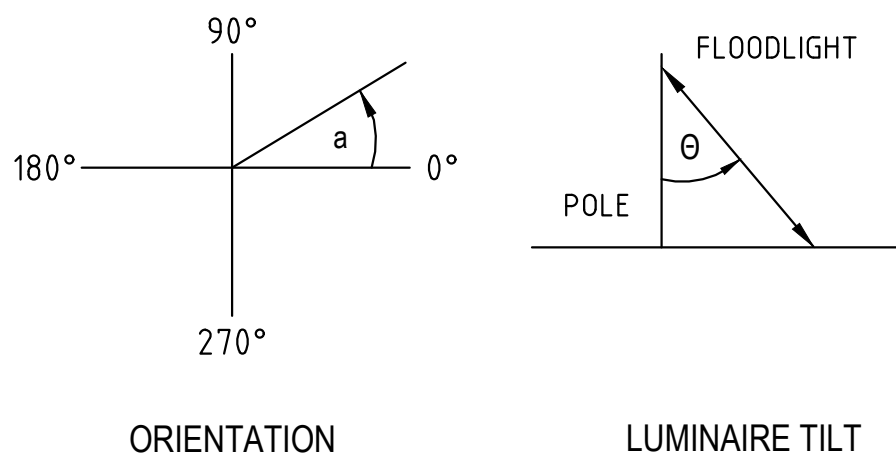

T2	TENDER	28.10.20	P.M.	R.H.
T1	TENDER	21.10.20	P.M.	R.H.
ISSUE	REVISION	DATE	REVIEW	APPROVED



CONSULTING ELECTRICAL ENGINEERS LIGHTING CONSULTANTS TECHNOLOGY CONSULTANTS

WEBB AUSTRALIA GROUP (VIC) PTY LIMITED ACN 61 073 585 305
LEVEL 9, 128 EXHIBITION STREET MELBOURNE VIC 3000 AUSTRALIA
TELEPHONE 03 9652 0333 FACSIMILE 03 9652 0300 EMAIL melbourne@webbaustralia.com.au

CLIENT
CITY OF KINGSTON



PROJECT
KEELEY PARK, CLAYTON SOUTH
EAST OVAL: SPORTS LIGHTING UPGRADE

DRAWING
ELECTRICAL SERVICES
LIGHTING PLAN

DATE	SCALE	D	R	A
28.10.20	1:500 [A1]	A.P.	P.M.	R.H.

PROJECT	DWG NO	REVISION	NO IN SET
M222D	EL-01	T2	-

STATUS
TENDER

COPYRIGHT © WEBB AUSTRALIA GROUP (VIC) PTY LTD ABN 61 073 585 305. ALL RIGHTS RESERVED. THIS DRAWING MAY NOT BE REPRODUCED OR TRANSMITTED IN ANY FORM OR BY ANY MEANS IN PART OR IN WHOLE WITHOUT THE WRITTEN PERMISSION OF WEBB AUSTRALIA GROUP (VIC) PTY LTD. WEBB AUSTRALIA GROUP DRAWINGS ARE SCHEMATIC AND SHALL BE READ IN CONJUNCTION WITH ALL CONTRACT DOCUMENTATION. SHOULD ANY AMBIGUITY, ERROR, OMISSION, INCONSISTENCY, OR CONFLICT BETWEEN PARTS APPEAR TO EXIST IN THE DOCUMENTS, IMMEDIATELY NOTIFY THE CONTRACT ADMINISTRATOR IN WRITING.