

BON BEACH OVAL No.2

CANNES AVENUE, BON BEACH, VIC 3196

LEGEND OF SYMBOLS

	A (x°) LUMINAIRE PEAK BEAM ANGLE LUMINAIRE AND DISTRIBUTION TYPE (REFER LUMINAIRE DETAILS BELOW) LUMINAIRE AIMING DIRECTION
	NEW TAPERED OCTAGONAL GALVANISED STEEL POLE WITH CROSS ARM TO SUPPORT LUMINAIRES AS SHOWN P : DENOTES MAST HEIGHT 'x' : 'x' DENOTES POLE IDENTIFICATION NUMBER 'y' - POLE HEIGHT DETAILS : TAPERED OCTAGONAL GALVANISED STEEL POLE TYPE : "COSLEE" OR "INGAL EPS" FINISH: TO COLOUR NOMINATED BY COUNCIL (POWDER COATED)
	A (x°) 2kW (220,000 LUMEN) METAL HALIDE IP65 FLOODLIGHT WITH NARROW BEAM ASYMMETRICAL DISTRIBUTION LUMINAIRE : "PHILIPS" - OPTIVISION MVP507 CODE : MVP507 NB/60
	A (x°) + L SAME AS TYPE 'A', EXCEPT WITH REAR LOURVE L : INDICATES WITH REAR LOURVE B (x°) 2kW (220,000 LUMEN) METAL HALIDE IP65 FLOODLIGHT WITH MEDIUM BEAM ASYMMETRICAL DISTRIBUTION LUMINAIRE : "PHILIPS" - OPTIVISION MVP507 CODE : MVP507 MB/60
	x° LUMINAIRE PEAK BEAM ANGLE (NOTE : TILT ANGLE = PEAK BEAM ANGLE - 60°)

	NEW ELECTRICAL PIT (1100 x 1100) WITH CONCRETE LID (MIN)
	NEW UNDERGROUND CONDUIT ROUTE - BY DIRECTIONAL BORE ONLY (HD-UPVC CONDUIT - SIZES & QUANTITIES AS SHOWN)
	NEW OVAL 2 SPORTS LIGHTING DB, C/W LIGHTING CONTROLS
	CONTROLLED BY SWITCH 1
	CONTROLLED BY SWITCH 2



IMAGE 1 : OPTIVISION MVP507

SCOPE OF WORKS

- REFER TO DRAWING M223B ES-01 FOR SCOPE OF WORKS

NOTES

- REFER TO NOTES ON DRAWING M223B ES-01

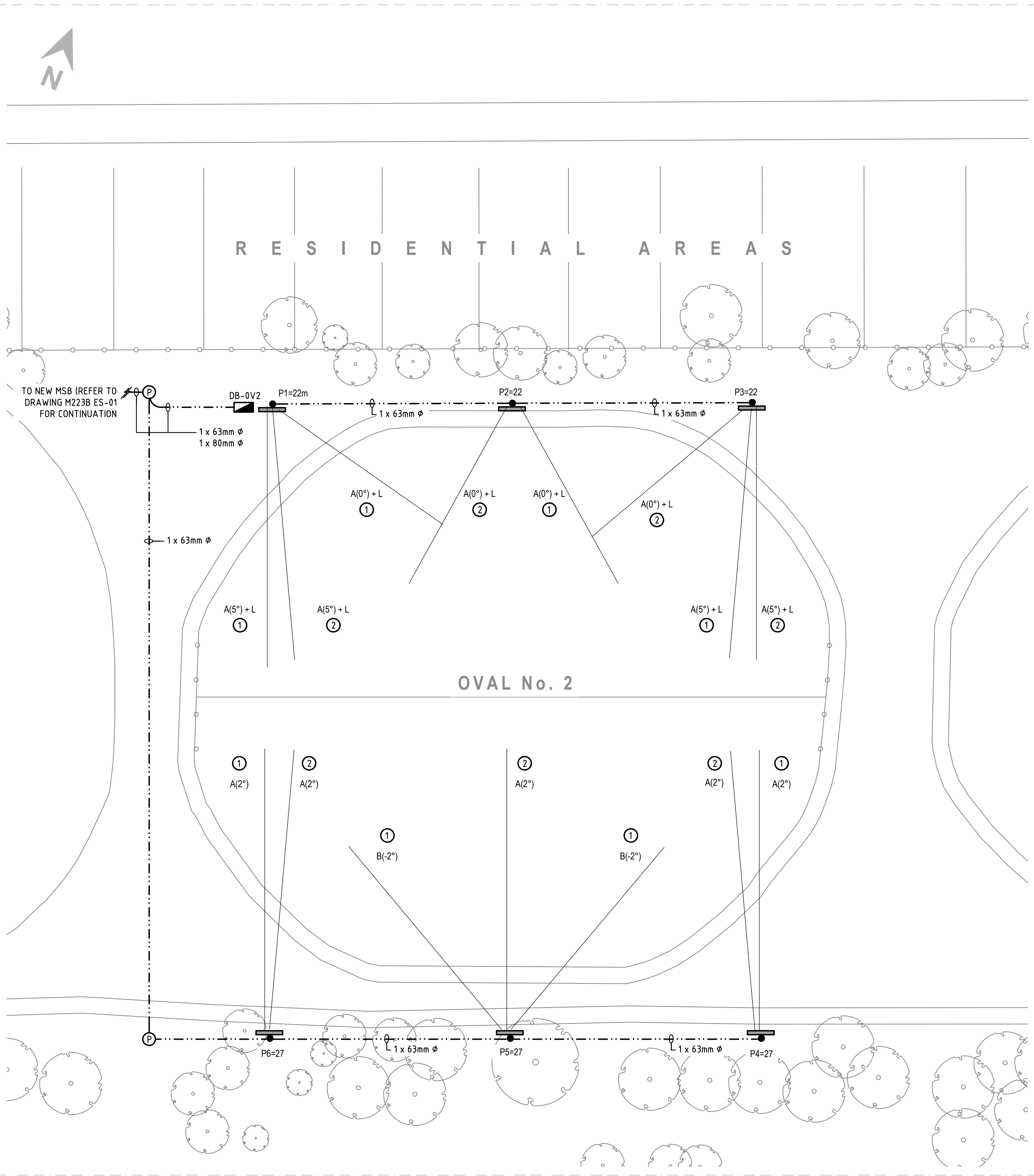

LIGHTING PLAN

SCALE 1: 500

C2	POLES P1,P2,P3 RELOCATED	18.11.20	P.M.	R.H.
C1	FOR CONSTRUCTION	29.09.20	P.M.	R.H.

ISSUE	REVISION	DATE	REVIEW	APPROVED
-------	----------	------	--------	----------



CONSULTING ELECTRICAL ENGINEERS LIGHTING CONSULTANTS TECHNOLOGY CONSULTANTS

WEBB AUSTRALIA GROUP (VIC) PTY LIMITED ACN 61 073 585 305
LEVEL 9, 128 EXHIBITION STREET MELBOURNE VIC 3000 AUSTRALIA
TELEPHONE 03 9652 0333 FACSIMILE 03 9652 0300 EMAIL melbourne@webb australia.com.au

CLIENT
CITY OF KINGSTON



PROJECT
BON BEACH OVAL 2
LIGHTING UPGRADES

DRAWING
ELECTRICAL SERVICES
LEGEND, NOTES & LIGHTING LAYOUT

DATE	SCALE	D	R	A
18.11.20	1:500 [A1]	JD	PM	WPH

PROJECT	DWG NO	REVISION	NO IN SET
M223C	ES-01	C2	-

STATUS
CONSTRUCTION

COPYRIGHT © WEBB AUSTRALIA GROUP (VIC) PTY LTD ABN 61 073 585 305. ALL RIGHTS RESERVED. THIS DRAWING MAY NOT BE REPRODUCED OR TRANSMITTED IN ANY FORM OR BY ANY MEANS IN PART OR IN WHOLE WITHOUT THE WRITTEN PERMISSION OF WEBB AUSTRALIA GROUP (VIC) PTY LTD. WEBB AUSTRALIA GROUP DRAWINGS ARE PRELIMINARY AND SHALL BE READ IN CONJUNCTION WITH ALL CONTRACT DOCUMENTATION. SHOULD ANY AMBIGUITY, ERROR, OMISSION, INCONSISTENCY, OR DISCREPANCY BE IDENTIFIED, IT SHALL BE THE RESPONSIBILITY OF THE CLIENT TO APPEAR TO EXIST IN THE DOCUMENTS, IMMEDIATELY NOTIFY THE CONTRACT ADMINISTRATOR IN WRITING.