

September 2025

Drainage Upgrade at Tippet Street, Clayton South

Every year we invest significantly in our roads, footpath, and drainage network to support the current and future needs of our community.

We plan to construct a new drainage network along Tippet Street and Second Street. These works will include the reconstruction of road pavement, kerb and channel, and footpaths to increase stormwater storage capacity (*plan overleaf*).

These improvements are designed to help address flooding issues in the neighborhood and enhance overall community resilience.

All significant trees will be retained, and tree protection measures will be in place during the works.

Construction details

Works are expected to start in mid-2026, and take around 12 weeks to complete (weather permitting).

Closer to the time of construction additional information will be provided, with details on who to contact during construction.

The construction works will restrict vehicle access to some properties for short periods of time. We will aim to minimise disruption and will provide signage for to guide alternative pathways.

We apologise for any inconvenience during the works and look forward to delivering these improvements for the community.

Further information

For further information relating to this project please contact Laura Wen, Design Engineer or Darren Stephens, Coordinator Major Designs via kingston.vic.gov.au/contact-us or on 1300 653 356.

To view other projects being constructed in your area please visit kingston.vic.gov.au/works



Kingston News.

Sign up to receive the latest updates from the City of Kingston.

📞 1300 653 356 ✉ info@kingston.vic.gov.au 🗣 Interpreter services - TIS National 📞 131 450

📍 1230 Nepean Highway, Cheltenham 3192 🌐 kingston.vic.gov.au 📬 PO Box 1000, Mentone 3194

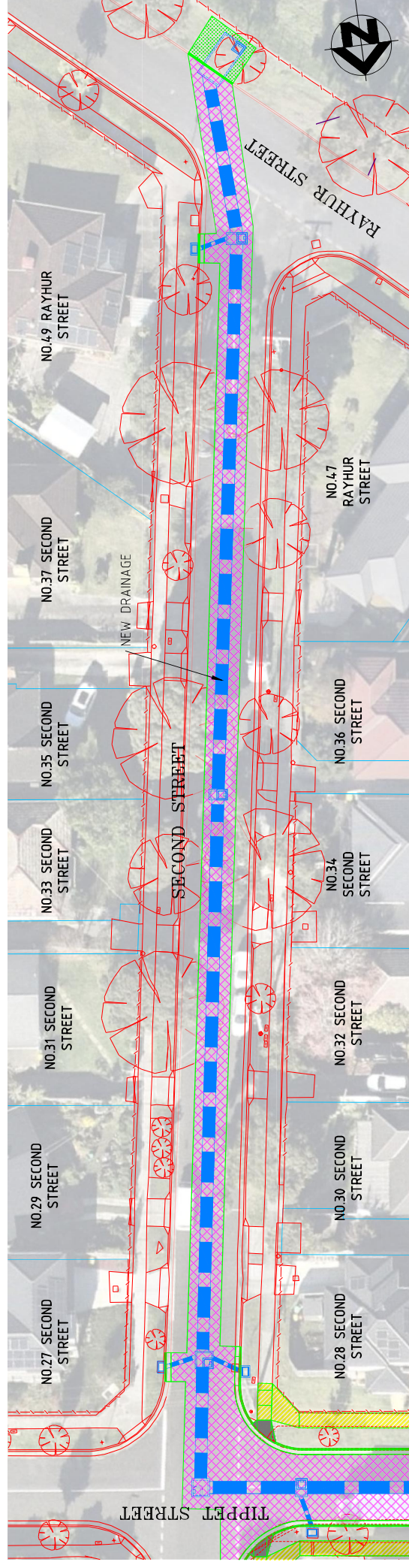
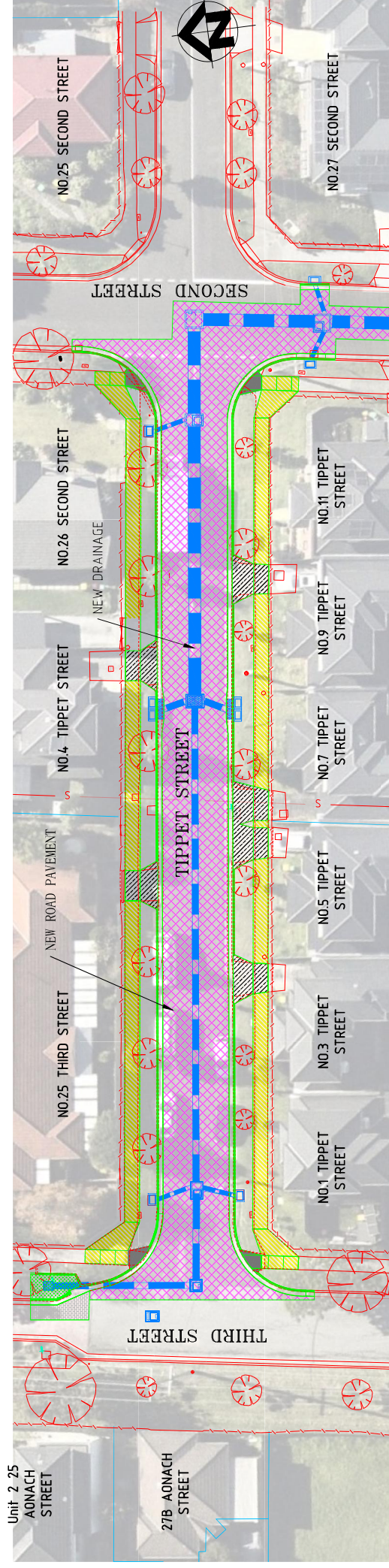

LEGEND	
	NEW KERB & CHANNEL
	NEW DRAINAGE PITS
	NEW DRAINAGE PIPES
	EXISTING
	NEW ROAD PAVEMENT
	NEW FOOTPATH
	NEW PRAM RAMP
	NEW VEHICLE CROSSING

TIPPET STREET, CLAYTON SOUTH DRAINAGE UPGRADE CONSULTATION PLAN