

March 2025

Residential Footpath Construction and Crossing Upgrades in Reeve Court, Cheltenham

Every year we invest significantly in Kingston's roads, footpath, and drainage network to support the current and future needs of our community – and are focused upon creating a cycling and pedestrian-friendly Kingston.

We plan to construct a residential footpath along Reeve Court, Cheltenham. This will improve access to Southland Shopping Centre for pedestrians and residents.

The improvements will include:

- A new 1.5m wide footpath on the western side of Reeve Court, spanning the entire distance from the south to the north.
- Removing the existing pram crossing, replacing it with new single direction pram crossings, as part of an upgrade to the Reeve Court/Radcliff Avenue roundabout.

Construction Details

Works will be completed in 2025/2026 and may take around eight to ten weeks to complete.

The construction may restrict access to some pedestrian areas for short periods of time. We will aim to minimise disruption and will provide adequate signage for alternative pathways.

Closer to the time of construction additional information will be provided, with details on who to contact during construction.

We apologise for any inconvenience during the works and look forward to delivering these improvements for the community.

Further information

For further information relating to this project please contact Luke Craig, Student Civil Design Engineer or Glenn Olin, Senior Design Engineer via email Info@kingston.vic.gov.au or on ☎ 1300 653 356.

To view other projects being constructed in your area please visit:
kingston.vic.gov.au → and select **'Projects and works'**



Kingston News.

Sign up to receive the latest updates from the City of Kingston.

☎ 1300 653 356 ✉ info@kingston.vic.gov.au 🗣 Interpreter services - TIS National 📞 131 450
📍 1230 Nepean Highway, Cheltenham 3192 🌐 kingston.vic.gov.au 📬 PO Box 1000, Mentone 3194

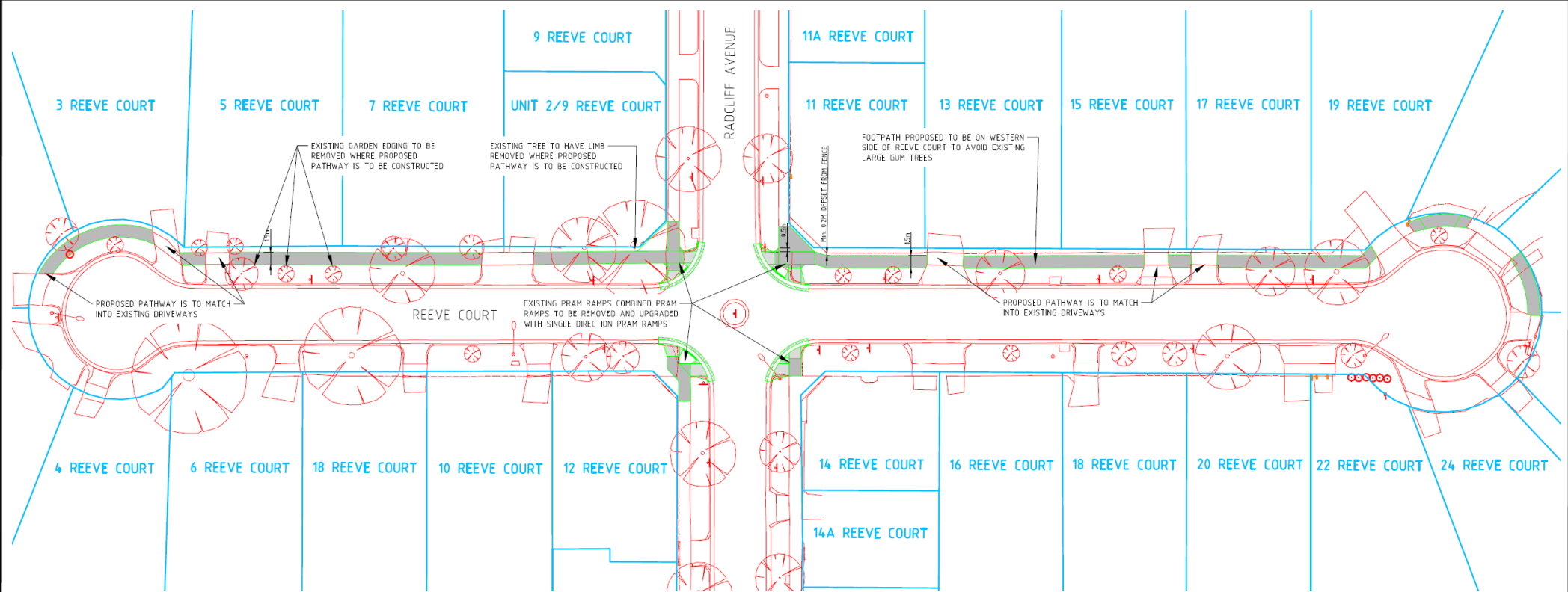

LEGEND

	EXISTING VEHICLE CROSSING		BOUNDARY LINES
	NEW 1.5M CONCRETE FOOTPATH		EXISTING KERB AND FOOTPATH
	NEW CONCRETE PRAM RAMP		EXISTING FOOTPATH ASSET TO BE REMOVED
	EXISTING SIGNS		EXISTING POWER POLES

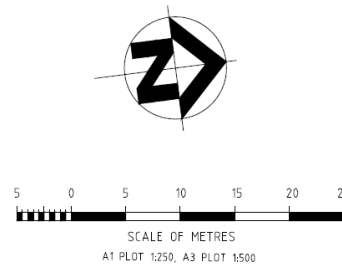

LOCATION OF WORKS

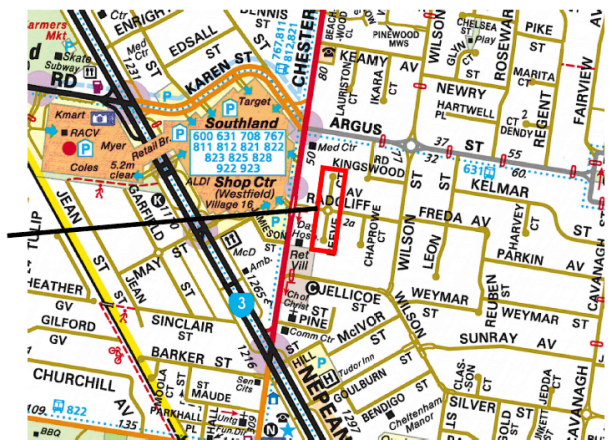

NOT TO SCALE

MELWAYS REFERENCE MAP 77 J12



City of KINGSTON

REEVE COURT, CHELTENHAM FOOTPATH CONSTRUCTION CONCEPT PLAN

FEBRUARY 2025